

SIDES Metres	DIRECTIONS	CO-ORDINATES Y System : WG. 31° X		S . G . No. 2368/2004
		Constants :	+/- 0.00	
A-B	107.18	291.30.20	A - 4 604.70	+ 5 925.30
B-C	48.91	21.18.30	B - 4 704.43	+ 5 964.59
C-D	107.69	111.26.20	C - 4 686.65	+ 6 010.16
D-E	0.48	201.52.00	D - 4 586.41	+ 5 970.80
E-A	48.56	201.53.40	E - 4 586.59	+ 5 970.35
		29-N1	⊕ - 4 658.14	+ 5 770.65
		32-N1	⊕ - 4 575.84	+ 5 979.05

Approved
[Signature]
Surveyor-General
2004-09-10

SERVITUDE NOTES :

- A. The figure e a b d represents a Party Wall Servitude 0,25 metres wide. Vide diagram S. G. No. 2925/2003 and Deed of Transfer No. 33246/2004
- B. The figure a f g b represents a Party Wall Servitude 0,25 metres wide. Vide diagram S. G. No. 2926/2003 and ~~Deed of Transfer No. 33246/2004~~

Disclaimer Notice

"Although every effort is made to provide for accurate and reliable information, The Ethekwini Municipality accepts no liability or responsibility whatsoever for the same on this plan. In case of council services, these must be used as a guide only. Details should be physically checked on site."

The figure A B C D E represents 5261 Square Metres of land, being **PORTION 73 OF ERF 12524 DURBAN**

- and comprises :-
1. The figure A a b D E representing Portion 53 of Erf 12524 Durban. Vide diagram S. G. No. 2925/2003 and Deed of Transfer No. 33246/2004
2. The figure a B C b representing Portion 54 of Erf 12524 Durban. Vide diagram S. G. No. 2926/2003 and

Situate in the eThekweni Municipality,
South Central Operational Entity,
Registration Division - FT,
Province of KwaZulu - Natal

Compiled in August 2004 by me

[Signature]
Professional Land Surveyor
J. M. Goosen
Registration No. PLS-0219

This diagram is annexed to
No.

File No. /59
S.R. No. : Compiled
Comp. : U37

Registrar of Deeds

PORTION 73 OF ERF 12524 DURBAN

S . G . No

2368/2004

Approved



Surveyor-General

2004-09-10

DESCRIPTION OF BEACONS :

A, B, C, D : 16mm iron peg

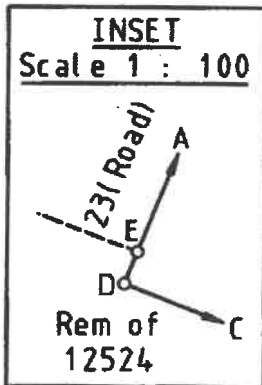
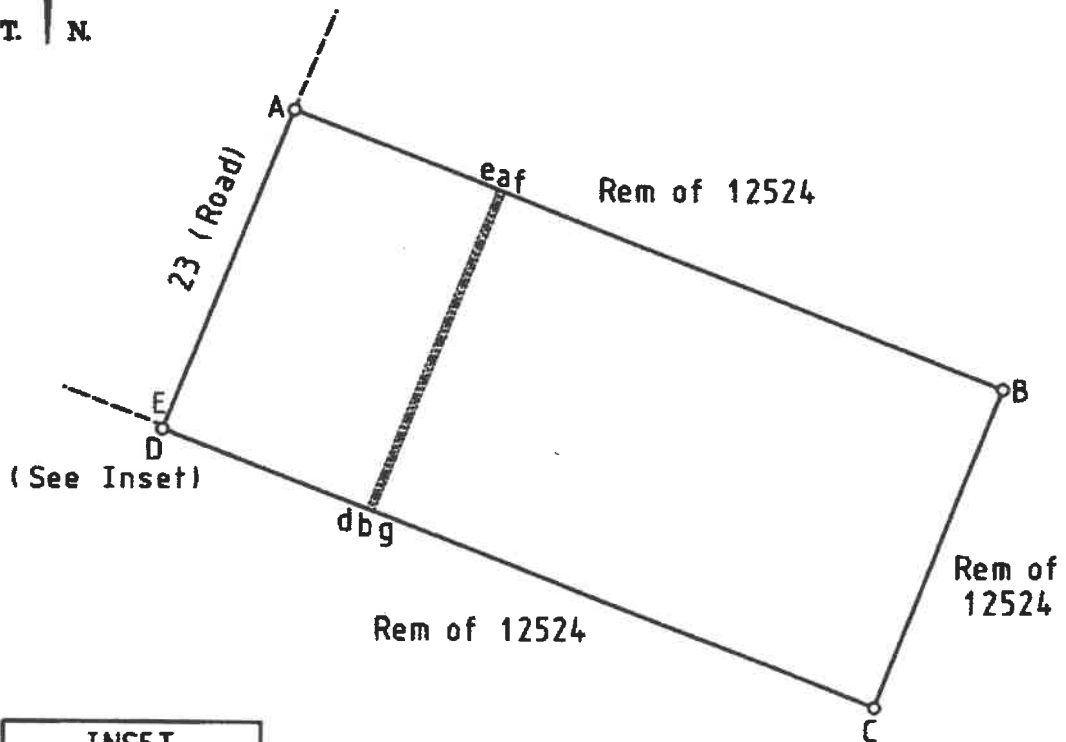

SCALE 1 : 1000

Compiled in August 2004 by me



Professional Land Surveyor
J. M. Goosen
Registration No. PLS-0219